

875 : Parking heater, D5244T4

XC90, 2007, D5244T4, TF-80SC AWD, L.H.D, YV1CM714671338226, 338226

12/12/2012



PRINT

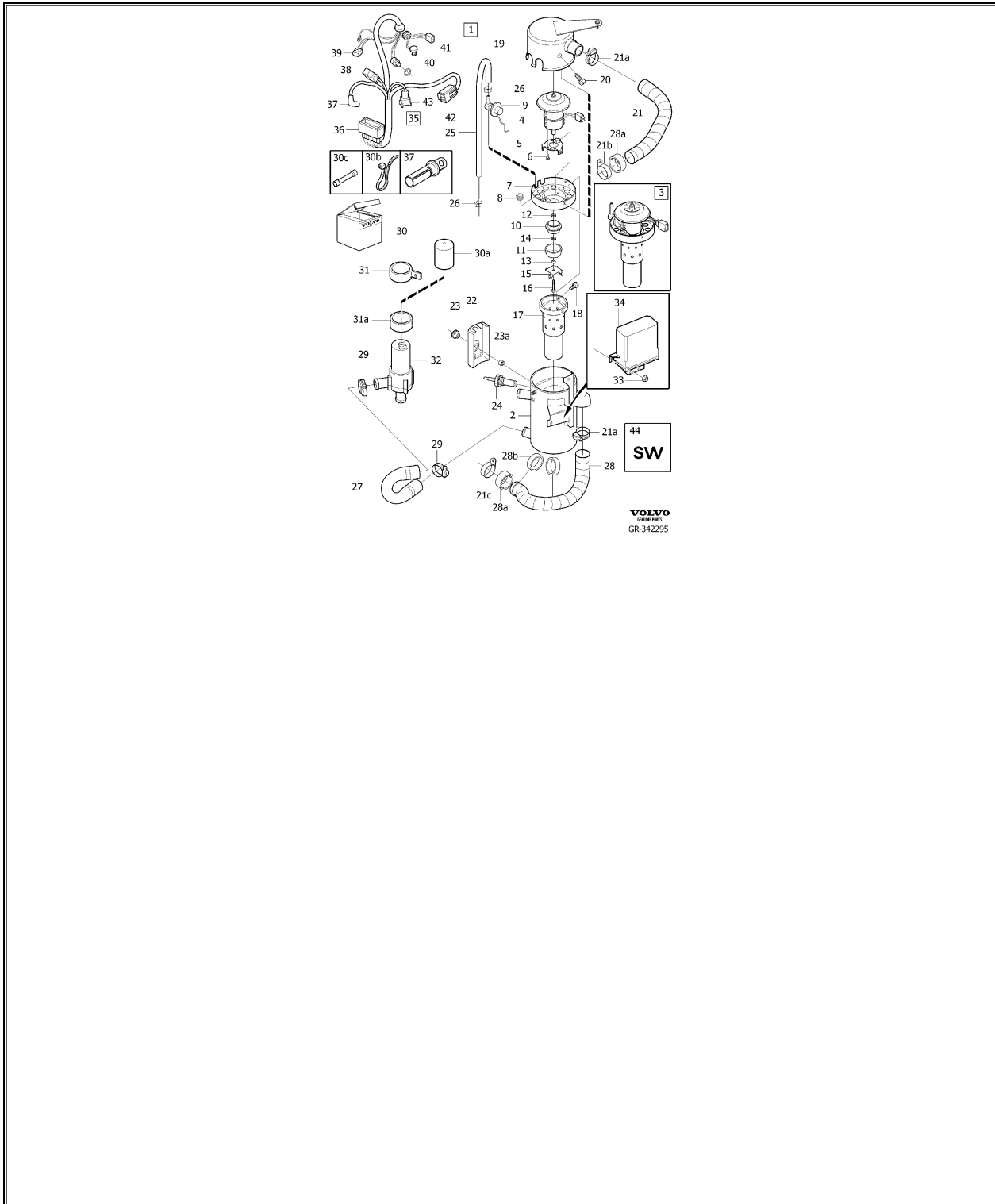

Fig.	Description	Qty.	PS	Part number
<input type="checkbox"/> 1	Parking heater (30738898), , (30762219)	1.00		30661775
<input type="checkbox"/> 2	* Heat exchanger	1.00		3731164

		(3730885)			
<input type="checkbox"/>	3	*	Burner unit	1.00	3731374
<input checked="" type="checkbox"/>	4	**	Fan motor	1.00	NS
<input checked="" type="checkbox"/>	5	**	Engine anchorage	1.00	NS
<input checked="" type="checkbox"/>	6	**	Cross recessed screw	1.00	NS
<input checked="" type="checkbox"/>	7	**	Engine anchorage	1.00	NS
<input type="checkbox"/>	8	**	Bushing	1.00	3714208
<input checked="" type="checkbox"/>	9	**	Pressure equalizer	1.00	NS
<input checked="" type="checkbox"/>	10	**	Fuel injection nozzle	1.00	NS
<input checked="" type="checkbox"/>	11	**	Outer cup	1.00	NS
<input checked="" type="checkbox"/>	13	**	Spacer	1.00	NS
<input checked="" type="checkbox"/>	15	**	Turbulator	1.00	NS
<input checked="" type="checkbox"/>	16	**	Screw	1.00	NS
<input type="checkbox"/>	17	**	Casing	1.00	3730128
<input type="checkbox"/>	18	**	Cross recessed screw	3.00	987046
		M4x8			
<input type="checkbox"/>	19	*	Fan shroud	1.00	3730513
<input type="checkbox"/>	20	*	Screw	3.00	3728963
<input type="checkbox"/>	21	*	Hose, intake	1.00	3730519
<input type="checkbox"/>	21a	*	Hose clamp	2.00	988025
		(983726)			
<input type="checkbox"/>	21b	*	Clamp	1.00	3729483
<input type="checkbox"/>	21c	*	Clamp	1.00	3729212
<input type="checkbox"/>	22	*	Cover	1.00	3730668
<input type="checkbox"/>	23	*	Nut	1.00	3730441
<input type="checkbox"/>	23a	*	Lock nut	1.00	985885
		M5x6.8			
<input type="checkbox"/>	24	*	Glow plug	1.00	3730104
<input type="checkbox"/>	25	*	Fuel hose	1.00	3731123
<input type="checkbox"/>	26	*	Hose clamp	2.00	978401
<input type="checkbox"/>	27	*	Hose	1.00	3730695
<input type="checkbox"/>	28	*	Hose, exhaust	1.00	3730520
<input type="checkbox"/>	28a	*	Protection	2.00	3730752
<input type="checkbox"/>	28b	*	Protection	2.00	3730688
<input type="checkbox"/>	29	*	Hose clamp	2.00	988025
<input type="checkbox"/>	30	*	Service kit, water pump	1.00	3730575
<input type="checkbox"/>	30a	**	Cap	1.00	31101178
<input type="checkbox"/>	30b	**	Cable tie	1.00	983750
		67			
<input type="checkbox"/>	30c	**	Splice	2.00	9130467
<input type="checkbox"/>	31	*	Clamp	1.00	3730670
<input type="checkbox"/>	31a	*	Tape rattle and squeak	1.00	9511095
<input type="checkbox"/>	32	*	Water pump	1.00	3729530
<input type="checkbox"/>	33	*	Flange nut	4.00	985919
		M6x6			
<input type="checkbox"/>	34	*	Control unit	1.00	30661721
		(3731003)			
<input type="checkbox"/>	35	*	Cable harness	1.00	3731393
		(31250748)			
<input checked="" type="checkbox"/>	36	**		1.00	
<input type="checkbox"/>	37	**	Cable terminal	1.00	1212901

		For connection to glow plug.			
<input checked="" type="checkbox"/>	38	**	1.00		
<input type="checkbox"/>	39	** Thermostat	1.00		3730414
<input type="checkbox"/>	40	** Sensor (3731267), , (31250749)	1.00		3731392
<input type="checkbox"/>	41	** Flame indicator	1.00		3713898
<input checked="" type="checkbox"/>	42	**	1.00		
<input checked="" type="checkbox"/>	43	**	1.00		
<input type="checkbox"/>	44	Heater/timer die system For adding software for the heater with timer, diesel.	1.00	SW	9438242
<input type="checkbox"/>		Fuel heater remove To remove the "fuel-driven parking heater" function.	1.00	SW	9438406
<input type="checkbox"/>		Additional heater appl DSL, For adding software for the auxiliary heater (parking heater).	1.00	SW	9488948

12/12/2012

PRINT